



CONFERENCE AND MEETING FACILITIES

Embrace productive meetings with a backdrop of palms and a shimmering sea. Treat your company to fresh seafood luncheons. Build your team with fun sessions on ATV adventure trails. Choose from a variety of state-of-the-art facilities to begin designing your bespoke corporate package at Anantara Mui Ne.

VENUES

L'Anmien Ballroom

Seat up to 160 people in our spacious 186 sqm ballroom. An ideal venue for company-wide meetings or banqueting.

Orchid

Choose a more intimate setting with the private Orchid. This room offers 51 sqm of space with seating for up to 20 people.

Jasmine

The mid-sized Jasmine is spacious 64 sqm with seating for up to 40 people.

Lily

The Lily accommodates up to 60 people within 74 sqm of space.

MEETING ROOMS	AREA		DIMENSION (WXLXH)		THEATRE	CLASS ROOM	U-SHAPE	BOARD ROOM	BANQUET 10	COCKTAIL	H-SQUARE
	SQM	SQ FT	METRES	FEET							
L'Anmien Ballroom	186	1984	9.8 X 19 X 3.5	32 X 62 X 11	160	100	100	-	100	170	-
Orchid	51	558	5.4 X 9.5 X 2.7	18 X 31 X 9	-	-	-	20	-	-	-
Jasmine	64	682	6.7 X 9.5 X 2.7	22 X 31 X 9	40	30	20	-	40	40	-
Lily	74	800	7.6 X 9.8 X 2.7	25 X 32 X 9	60	40	20	-	40	60	-

MEETING MAP

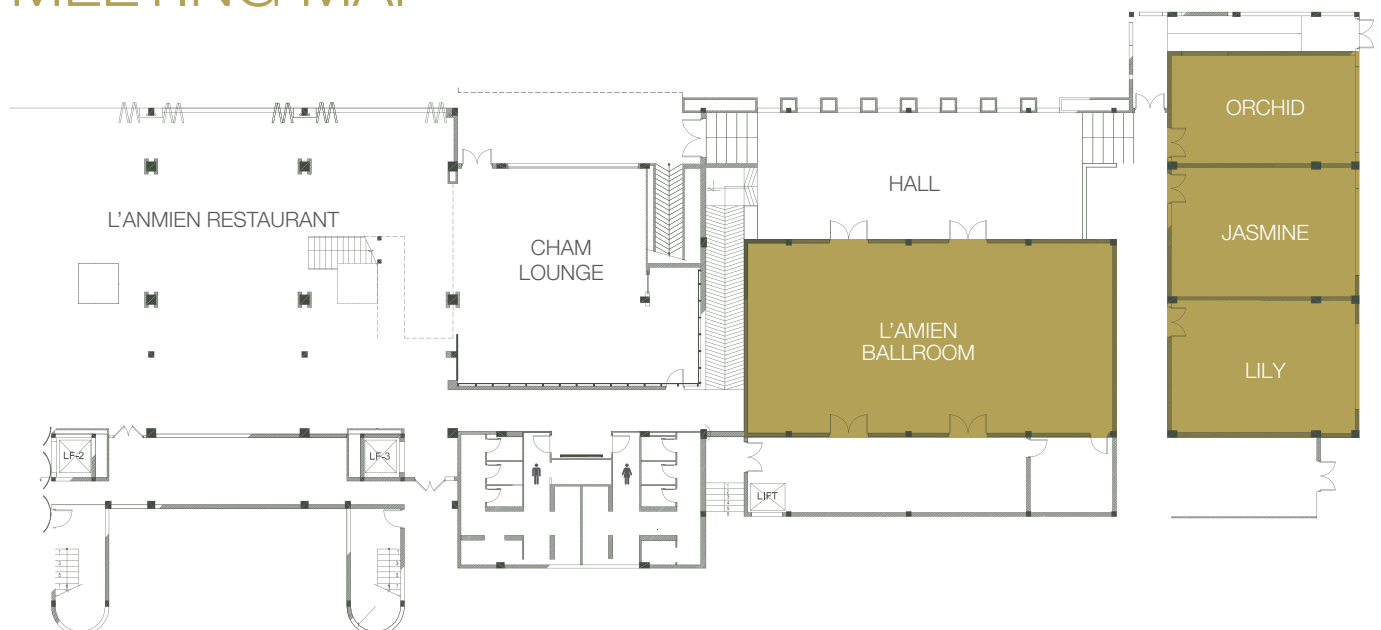

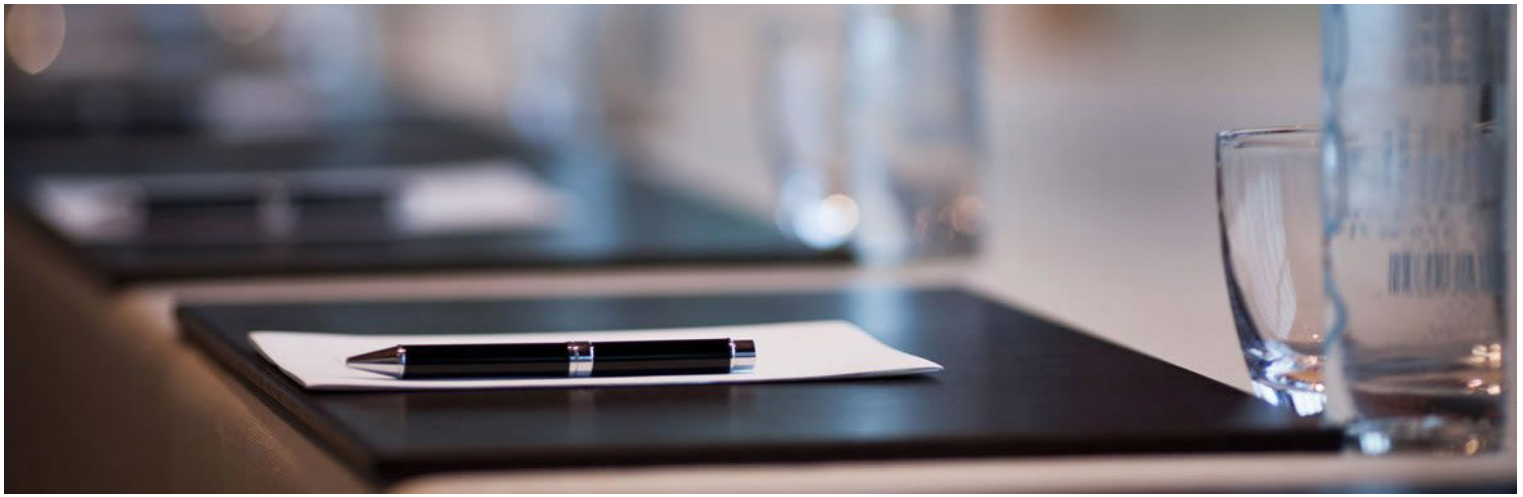

MEETING PACKAGES

Anantara Mui Ne Resort combines State of the art technology and world-class facilities services by the resort's well-trained banquet team. The Anantara Meeting room accommodates up to 55 guests for medium sized corporate events of team building activities, with wireless internet offering immediate access to the head office of company website.

- | | |
|--------------------------------------|--------------------------|
| • Full-Day Package (with lunch) : | USD 42++ per participant |
| • Full-Day Meeting (without lunch) : | USD 38++ per participant |
| • Half-Day Package (with lunch) : | USD 31++ per participant |
| • Half-Day Meeting (without lunch): | USD 20++ per participant |

Package Inclusion

- Usage of meeting room from 08:00 – 17:00 hour
- Two coffee breaks (am/pm) with sweets or snacks
- Unlimited coffee/tea throughout the meeting
- Lunch at a private section or outlets (upon availability) to be selected from:
 - Vietnamese/International buffet
 - Asian set lunch
 - 3-course Western set lunch

Standard Set Up

- Podium with microphone
- Flipchart & whiteboard with markers
- Overhead projector, screen
- Laser pointer, writing materials
- Signboard arrangement
- Complimentary mineral water
- Candies

Condition:

- Rates are subject to 5% service charge and 10% VAT
- The package is based on a minimum of 20 persons