



ANANTARA  
THE MARKER · DUBLIN  
HOTEL



## ANANTARA THE MARKER DUBLIN HOTEL

One of Dublin's most visually architectural landmarks, Anantara The Marker Dublin Hotel offers a distinct blend of urban style and luxury. Located right in the heart of the Docklands, Dublin's most prolific cultural hub, it's the perfect base from which to explore Ireland's capital city.

Extraordinary, surprising and luxurious, Anantara The Marker Dublin Hotel is an unforgettable urban retreat for those who crave the unconventional, yet still expect the exceptional standards of service that are the signature of a member of The Leading Hotels of the World™.

Address:	Grand Canal Square, Docklands, Dublin 2, D02 CK38, Ireland
Telephone:	+353 (01) 687 5100
Email:	<a href="mailto:themarker@anantara-hotels.com">themarker@anantara-hotels.com</a>
Web Address:	<a href="http://themarker.anantara-hotels.com">themarker.anantara-hotels.com</a>





## LOCATION

Anantara The Marker offers contemporary urban luxury overlooking the Grand Canal Square's waterfront. Perfectly located in the modernised Docklands, the hotel captures the unique mix of vibrant charm and rich culture that exemplifies the spirit of modern Dublin.

Originally a significant Viking Settlement and Port, Dublin's character has been shaped by architecture spanning from medieval to modern times. Built by the greatest engineers of the age, the Grand Canal Docks were the final point of the Grand Canal (An Chanáil Mhór), connecting Dublin, in the east of Ireland, with the River Shannon in the west, via a series of villages and towns.

In recent years, the area has developed to become one of the trendiest places to live, work and play in Dublin. It is home to the headquarters of numerous global players in the banking, legal and tech sector. With companies such as TikTok, Google and AirBnB choosing Grand Canal Dock as their base, the futuristic area has become affectionately known as "Silicon Docks".

Management:  
Ownership:  
General Manager:

Anantara Hotels, Resorts & Spas  
Deka Immobilien  
Michael Davern





## ANOTHER MILESTONE IN HISTORY

The hotel name 'The Marker' is a mark of respect for one of the greatest inland trade routes, the Grand Canal. The direct link with the exotic trading hubs of Europe, the Grand Canal's 82 miles were lined with cast iron 'markers'. These markers were like milestones, showing travellers how far they had to go until journey's end. The final marker was right where the hotel is located now, in Grand Canal Square. Inspired by the innate Irish love of adventure, travel and trade, the hotel's name embodies this rich history, giving it a new sense of place in a contemporary context.

The building's architecture draws on the elemental nature of the Irish landscape and combines it with a sleek urban aesthetic, creating an experience that is distinctly authentic and truly inimitable. Inspiration comes from the geometric shapes that exist naturally on the Irish island, from the rugged Burren Landscape to the unique hexagonal stones of the Giant's Causeway.

This elemental style seamlessly extends from the stunning ground floor bar and restaurant, through to the unique geometric layouts of our 187 bedrooms, to the breathtaking rooftop Bar & Terrace, reaching across the cityscape to the wild natural beauty of the mountains and the Irish Sea.



## ACCOMMODATION

Most rooms and suites have striking views over Grand Canal Square and the Docklands, to the Dublin and Wicklow mountains and the Dublin Bay. Bathed in natural light, spacious and designed with supreme comfort and style, all guest rooms set a new standard in city living.

### Deluxe Room

Deluxe Rooms harmonise beauty and functionality, with ergonomic furnishings and high-tech amenities designed in a sleek, contemporary style. The bespoke furniture has been crafted by Irish designers, while original artwork showcases some of the best home-grown talent. The bathroom is indulgent, with floor-to-ceiling marble creating an astonishing sanctuary, and luxurious toiletries exclusively by VOYA.

### Premium Room

In addition to all the style and comforts of a Deluxe Room, the Premium Rooms are perfectly positioned to offer guests an impressive and sweeping view of Grand Canal Square. High-tech amenities range from an interactive entertainment system to a Nespresso Zenius machine. Make a fresh brew, then sink into an Eames-style chair or Villeroy & Boch marble bathtub.

### Premium Room View

Premium Room with View is a bright and spacious room with a view over Bord Gáis Energy Theatre. High-tech amenities range from an interactive entertainment system to a Nespresso Zenius machine.

### Premium Grand Canal View Room

Premium Room with Grand Canal View highlight the hotel's impressive and sweeping view over Grand Canal Square and the waterfront. High-tech amenities range from an interactive entertainment system to a Nespresso Zenius machine.

### Junior Corner Suite

Corner Suites are ideal for business travellers or families, with extra space to work, lounge and rest. Natural sunlight falls on the desk with Eames-style chair, a freshly brewed espresso is at your fingertips, and cots can be added for children with space easily left over for play.

### Junior Corner Suite with View

Wake up to views of water beside the bustling Grand Canal Square, the cityscape beyond, and then the misty Wicklow Mountains in the distance. The luxurious Junior Corner Suite with View epitomises modern elegance, with original Irish artworks and plush colourful fabrics adorning the light space.

### One Bedroom Suite

With a separate living room brimming with plush rugs, pillows and throws, a designer sofa set and original paintings, our two One Bedroom Suites are the home away from home you never had. Choose from The Roche, named after Dublin-born Nobel Prize architect of Convention Centre Dublin, which overlooks the iconic building or The Schwartz, named after the Grand Canal Square designer, showcasing sixth floor views of the square.





## Presidential Suite

An expansive 129 square metres (1400 sq ft.); The Presidential Suite is located on the unhampered fifth floor that boasts unobstructed views of Grand Canal Square and iconic architectural landmarks – both old and new – that make up the city’s unique fabric. Two bedrooms with ensuites open onto a breakfast room and separate living room decked out in comforts from specially commissioned furnishings and art to a Nespresso machine.

### Room features and amenities

- King or twin bed
- International satellite LED TV with Chromecast system
- WiFi
- Work desk with international power sockets
- Individually controlled air conditioning
- Mini bar
- Nespresso coffee machine
- Tea by Solaris
- Exclusive toiletries by VOYA

### Guest services

- 24-hour room service
- 24-hour business centre for computer access and printing
- Secretarial services
- Valet parking
- Laundry and dry-cleaning services

ROOM TYPE	TOTAL		ROOM SIZE		ACCEPT ROLL AWAY BED	MAX GUESTS
			(SQM)	(SQFT)		
Deluxe Room	42		30	323	No	2
	29 King	13 Twin				
Premium Room	73		30	323	No	2 + 1 infant
	55 King	18 Twin				
Premium Room View	43		30 - 35	323 -377	No	2 + 1 infant
Premium Grand Canal View Room	8		30 - 35	323 -377	No	2 + 1 infant
Junior Corner Suite	14		40 - 44	430 - 473	Sofa bed	3 Adults
	13 King	1 Twin				
Junior Corner Suite with View	4 King		40 - 44	430 - 473	Sofa bed	3 Adults
One Bedroom Suite	2 King		85 - 91	915-980	Yes	3 Adults
Presidential Suite	1 King		129	1388	Yes	4
Accessible Rooms	8 King		35	377	No	2



## RESTAURANTS AND BARS

Executive Head Chef, Gareth Mullins is known for artistically crafting all menu design and food preparation in the hotel's restaurants and bars. With over 20 years' experience cooking in five-star hotels in Ireland and Australia, Gareth leads a talented team. His passion for sourcing local Irish produce is found in each recipe he creates. This passion is reflected in Gareth's Commissioner General of Eurotoques Ireland which consists of 200 of the country's best-known chefs, producers and educators with an aim to protect our Irish culinary heritage and inspire future generations.





## Forbes Street by Gareth Mullins

The finest seafood and steaks and other goodies from the best producers in the land and sea. In true Dublin fashion, there's a story behind everything on the menu.

### Opening hours:

#### Lunch

Thursday – Friday: 12.30 pm - 2.00 pm

#### Dinner

Monday – Sunday: 5.00 pm - 10.00 pm

**Seating capacity:** 110

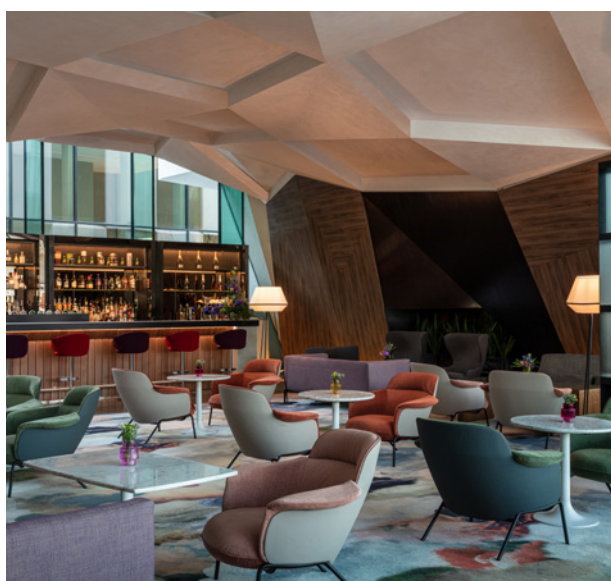

## The Marker Bar

The Marker Bar buzzes from morning till night – Relax with an espresso, or enjoy lunch with selection of light and classic dishes. When the markers illuminate, indulge in a delectable dinner with our eclectic selection of modern fare and sip on curated cocktails.

### Opening hours:

Monday – Thursday: 9.00 am – 11.00 pm

Friday – Saturday: 9.00 am – 12.00 am

Sunday: 9.00 am – 11.00 pm

Kitchen: 12.00 noon – 8.00 pm

**Cuisine:** Gastropub with Irish fare

**Seating capacity:** 70



## The Rooftop Bar & Terrace

The rooftop flows from indoors to out, a mix of intimate and social areas. 360° views extend to the mountains on one side and the Irish Sea on the other. Relaxed all day alfresco dining moves towards a more upbeat ambience at sunset. Head up for cocktails and a sharing platter at this destination for style conscious urbanites.

### Opening hours:

Opening hours are subject to change, please check our website for seasonal updates.

**Cuisine:** Drinks & Light Bites

**Seating capacity:** 120



## In-Room Dining

Offering gourmet flavours at any time of the day or night, the in-room dining menu offers guests fresh, Irish dishes. From breakfast in bed, a healthy snack, midnight munchies or a sinfully indulgent dessert, relax in comfort and let us bring a dinner experience to your room.

**Opening hours:** 24 hours daily



## CONFERENCE AND MEETING FACILITIES

Anantara The Marker is your choice for events infused with authentic local colour and a range of customised experiences. With capacities ranging for 6 to 350 people, the hotel offers a unique backdrop for small-to-large scale meetings, events and conferences. The nine state-of-the-art meeting rooms are visually impressive and include video conferencing, multi-media equipment, LCD displays, WiFi and air-conditioning. Most meeting spaces boast natural daylight, looking out onto Chimney Park, an iconic landmark and a surprising hidden treasure, tucked into the contrasting urban landscape. Three of the rooms have direct own-door access to Chimney Park, creating even more flexibility.

Dedicated meeting and event coordinators ensure every element flows seamlessly, from VIP welcome gifts and the ideal music, themed decor and entertainment, to innovative catering options and impeccable service to enrich the experience.

MEETING ROOM	AREA (SQF)	AREA (SQM)	DIMENSIONS (IN M LxWxH)	BANQUET	BOARD ROOM	CLASS ROOM	COCKTAIL	U-SHAPE	THEATRE	CABARET	DAYLIGHT
The Marker One	1905	177	12 x 14 x 4.7	110	34	102	190	43	150	80	No
The Marker Two	1905	177	12 x 14 x 4.7	110	34	88	160	43	130	70	No
<b>combined</b>	<b>3810</b>	<b>354</b>	<b>12 x 28 x 4.7</b>	<b>240</b>	<b>68</b>	<b>180</b>	<b>350</b>	<b>86</b>	<b>300</b>	<b>170</b>	<b>No</b>
The Carnac	320	29	5.4 x 5.5	10	12	15	23	12	23	8	Yes
The Hamilton	296	27	5.4 x 5.1	10	10	6	-	10	16	8	No
<b>combined</b>	<b>616</b>	<b>57</b>	<b>5.4 x 10.6</b>	<b>24</b>	<b>24</b>	<b>22</b>	<b>58</b>	<b>22</b>	<b>42</b>	<b>21</b>	<b>Yes</b>
The Omer	519	48	5.4 x 10.6	10	8	8	23	10	25	8	Yes
The Broadstone	282	26	4.9 x 5.35	10	10	8	-	10	16	8	No
<b>combined</b>	<b>802</b>	<b>74</b>	<b>4.9 x 14.7</b>	<b>24</b>	<b>26</b>	<b>26</b>	<b>51</b>	<b>26</b>	<b>51</b>	<b>28</b>	<b>Yes</b>
The Hibernia	474	44	4.3 x 10.1	30	26	22	42	-	42	21	Yes
The Aqueduct	189	17	4.3 x 4.1	10	8	-	-	-	12	7	No
<b>combined</b>	<b>657</b>	<b>61</b>	<b>4.3 x 14.2</b>	<b>32</b>	<b>28</b>	<b>30</b>	<b>72</b>	<b>-</b>	<b>72</b>	<b>28</b>	<b>Yes</b>
The Shannon	1011	94	6.5 x 14.5	60	32	55	100	36	110	47	Yes



# FLOOR PLAN

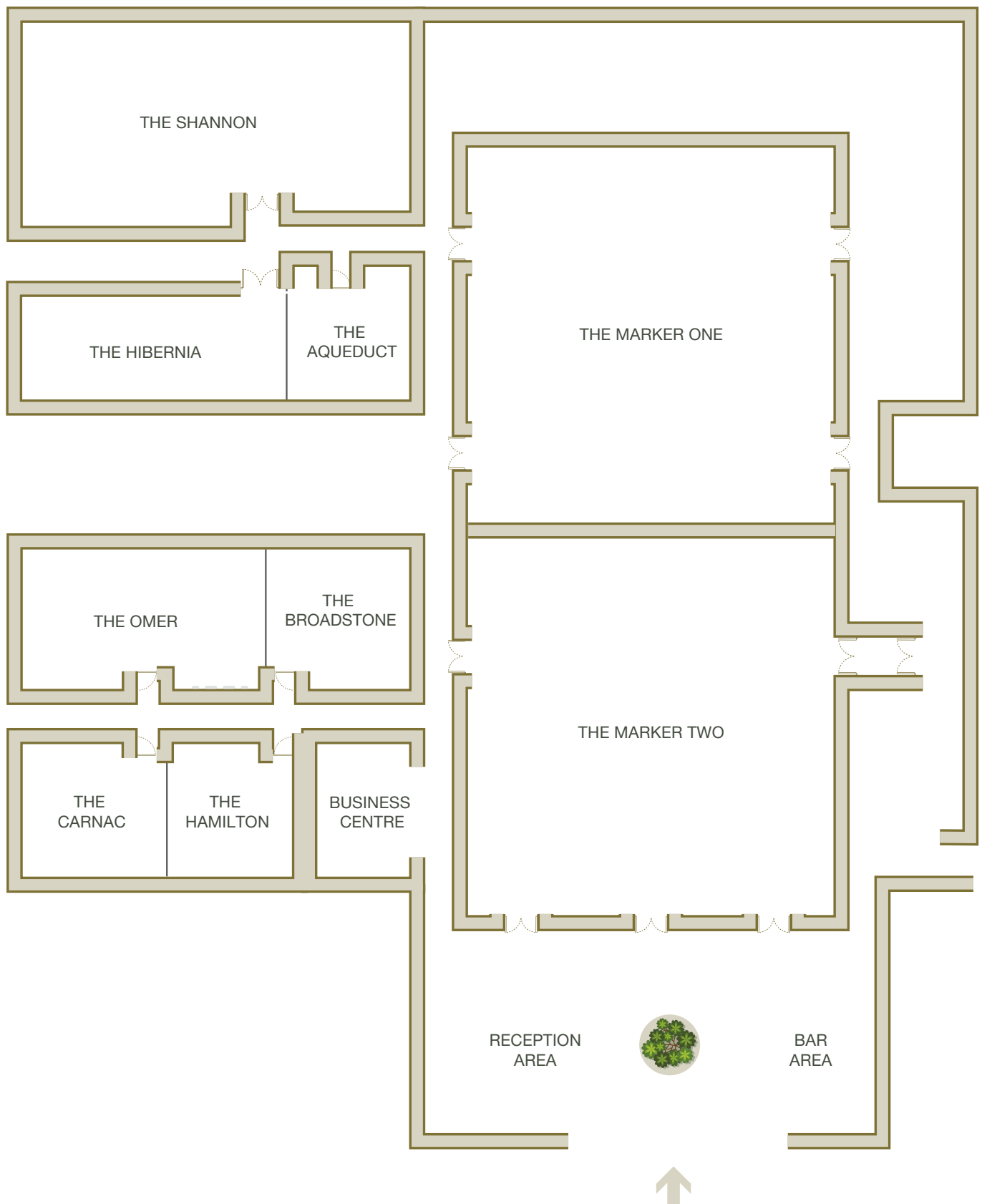



## WEDDINGS AND SPECIAL OCCASIONS

At Anantara The Marker, wedding celebrations are stylish, intimate and utterly bespoke, with a team of planners and chefs to perfect your special day. Exchange vows on the rooftop as the sun sets over the city, or say “I Do” in one of the stylish indoor locations. From small, intimate, private gatherings for your nearest and dearest to lavish affairs for up to 240 guests, at Anantara The Marker we’ll ensure that your special day is just as individual as you.

We can assist to plan wonderful honeymoon experiences; a champagne breakfast in bed, a sensual spa journey, romantic picnic and candlelit dinner, or find out about once in a lifetime honeymoons at Anantara Hotels, Resorts & Spas across Europe and Asia, and other exotic destinations worldwide.





## RECREATION AND LEISURE

Anantara The Marker embodies the ideal balance of bustling business hub and authentic city discovery. World class leisure facilities make relaxation a pleasure, while extensive business facilities make doing business easy.

At Anantara The Marker, we take a holistic approach to wellbeing, helping you lead a healthier lifestyle while still enjoying life to the full. Start your day with a seasonal raw juice and energising waterside views. Salute the sun with yoga on the rooftop while you surround yourself with mountaintop views. Heal at the award-winning spa with therapies from East and West.

### Hotel Leisure Facilities & Services

Time out from the city comes with ample choice at Anantara The Marker. A refreshing morning dip in the infinity pool and then going for a relaxing massage. Staying in shape with a workout or enjoying sunset cocktails at the Rooftop Bar & Terrace. For real culinary enthusiasts, Spice Spoons cooking school invites you to master Ireland's premium ingredients and unique flavours with an expert chef who is happy to share their secrets.

- The Anantara Spa with 5 treatment rooms
- 23 metre indoor infinity pool (75 feet)
- Jacuzzi
- Eucalyptus-infused steam room
- Sauna
- Relaxation areas
- Gym with personal training classes
- Courtesy Bicycles

Opening hours gym, pool & thermal area:  
Monday - Friday: 6.00 am to 9.30 pm  
Saturday, Sunday & Bank Holidays: 7.00 am to 8.00 pm



## WILD SWIMMING

Experience Ireland's stunning coastal landscapes, embrace wild swimming for exploration and water therapy. Immerse yourself in refreshing dips and plunge into the invigorating cold waters with potential sightings of wild seals and dolphins.

Add-ons:

- Breakfast By Design
- Picnic Basket
- Customised Spa Treatments



## CRAFTING AN IRISH COFFEE

Immerse yourself in a sensory delight as you savour the rich flavours of Ireland, delving into the art of crafting an exquisite Irish coffee guided by a local coffee master and mixologist. In this captivating experience, the hidden secrets of this iconic beverage will be revealed, allowing you to unlock the essence of true Irish craftsmanship and history.

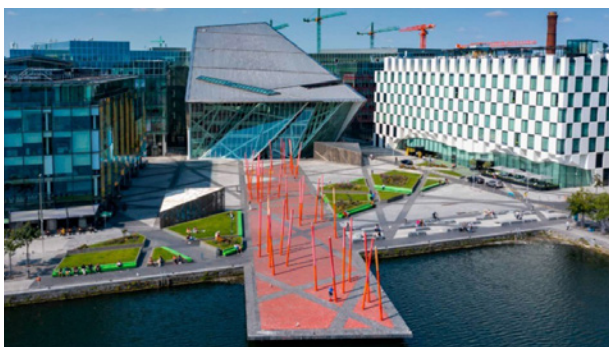

## DOCKLANDS WALKING TOUR

Experience a captivating journey through Dublin Docklands, where vibrant history and enchanting tales spring to life. Join renowned Irish storytelling Guru, Derek Brennan, on an enthralling walking tour.



## IRISH NATIONAL STUD AND GARDENS

See some of the world's top stallions at the Irish National Stud, and see them in their stables or out in their paddocks. A private guide will tell you all about the horses and will take you through their breeding and pedigrees.



## ROYAL DUBLIN GOLF CLUB

Luxuriate in an extraordinary golf escapade at Royal Dublin Golf Club, complete with chauffeur-driven arrival, personalised orientation, and a delightful post-game whiskey tasting on the hotel's picturesque 360-degree rooftop.





## ANANTARA SPA

The award-winning and luxurious Spa at Anantara The Marker offers a haven of wellbeing in the middle of the city. The Spa facilities include five treatment rooms offering a range of body treatments and massages to help find balance based on the five elements. Beautify with advanced skincare from SkinCeuticals and Rejuvapen micro-needling.

### Signature Spa Treatments

#### **The Dream (90 mins)**

A luxurious coconut and herbal steam exfoliation on the back to help buff, hydrate and prepare the skin for the massage. The massage is a heavenly back massage treatment using the 'Tree of Life Balm' applied in a warm and enveloping sequence to help feed the skin with nutrients and help ease tight and tender muscles. The dream facial treatment is customised to give your skin the perfect luminosity boost. To finish, your feet are pampered with a farewell foot ritual using a refreshing circulation serum to help reduce puffiness before ending with a blissful foot massage to rejuvenate tired and aching feet.

#### **Elemental Herbology Five-Element Aroma Facial**

Bespoke to each guest, this transformative facial combines healing botanicals, vitamins and marine extracts to replenish the skin and restore equilibrium, creating a more vibrant and healthy complexion.

View all spa treatments at [themarker.anantara-hotels.com](http://themarker.anantara-hotels.com) under Spa Brochure

Opening hours:

Monday – Friday: 11.30 am – 8.00 pm

Saturday: 9.30 am – 6.00 pm

Sunday: 10.00 am – 7.00 pm



## LOCAL AREA EXCURSIONS

Our central location means that you can enjoy all the perks of a luxury hotel, yet you're never too far from the best-loved landmarks and attractions Dublin has to offer. Experience the exhilaration of a live rugby match at the Aviva Stadium, meander along the canal and immerse yourself in historic Dublin or enjoy a West End show at the Bord Gais Theatre opposite to the hotel.

Explore the vibrant Docklands and nearby cultural entertainment and historical sites.

- Bord Gáis Theatre
- Windmill Lane Recording Studios
- EPIC The Irish Immigration Museum
- Convention Centre Dublin
- Trinity College Dublin
- St. Patrick's Cathedral
- National Gallery of Ireland
- Jameson Distillery Bow St.

## AIRPORT TRANSFERS

Dublin Airport is approximately a 25-minute drive from the hotel and offers direct and connecting services to various destination worldwide. Private transfers can be arranged at the hotel.

- Dublin Airport (DUB) 12.5 KM
- Luas (tram) stop is Mayor Square 0.8KM
- Dublin Bus 0.1KM

**Voltage** 230 V, 50 Hertz

**Currency** Euro

**Time Zone** Winter GMT  
Summer GMT +1

**Climate** Winter: November to January 7°C – 10°C (45°F – 50°F)  
Spring: February to April 8°C – 12°C (46°F – 54°F)  
Summer: May to July 17°C – 20°C (64°F – 68°F)  
Autumn: August to October 14°C – 17°C (57°F – 64°F)

**Special Holidays** St Patrick's Day is a global celebration of Irish culture yearly on 17 March. It particularly remembers St Patrick, one of Ireland's patron saints, who ministered Christianity in Ireland during the fifth century.





**ANANTARA**  
THE MARKER • DUBLIN  
HOTEL

A MEMBER OF  
  
THE LEADING HOTELS  
OF THE WORLD®

Anantara The Marker Dublin Hotel, Grand Canal Square, Docklands, Dublin 2, Ireland.  
T +353 1 6875 100 E [themarker@anantara-hotels.com](mailto:themarker@anantara-hotels.com)